

# Students' Union UCL

## The Student Hub - Lewis's Building



Study Space  
Shared Events Space

Also...  
Richard Mully's Bar  
George Farha Cafe  
Huntley Pub

The Lewis's Building at Gower Street already provides a number of bars and cafe spaces. Currently the George Farha cafe attracts footfall from Euston station and the Huntley Pub and Richard Mully's Bar already host a number of student events. As such, this building is already suited to being the focus of the food and drink offers for the Union.

The spaces on the first and second floor, which will be freed up due to the consolidation of Union staff within 25 Gordon Street, lend themselves to becoming study areas - replacing the Wolfson Study Space on the second floor of 25 Gordon Street with much better, improved spaces for students. These moves enables the Union to improve it's commercial offer and focus on catered hot food.



Richard Mully's Bar

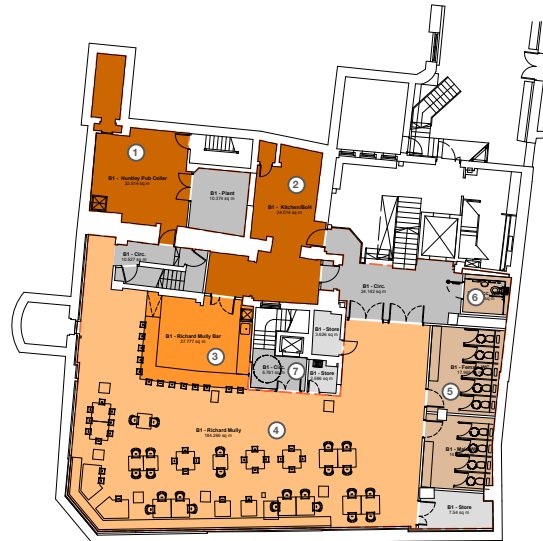

Basement Floor Plan

- 1 Huntley's Pub cellar retained
- 2 New kitchen to provide food to Richard Mully's bar
- 3 Relocation of Mully's bar to allow for it to be larger with a dumb waiter to George Farha cafe on the ground floor.
- 4 New flexible, stackable furniture to allow for removal during events.
- 5 Reconfiguration and refurbishment of female and male WCs.
- 6 New accessible WC at entrance to comply with Part M of the Building Regulations and BS 8300.
- 7 Reconfiguration of lobby to ensure compliance with Part M of the Building Regulations and BS 8300.



Ground Floor Plan

- 1 Removal of fixed furniture items within Huntley Pub. Replaced with flexible furniture items. Entry door replaced so that it can be used from the street.
- 2 George Farha cafe moved to improve visibility and to allow for dumb waiter link to Richard Mully's in basement. This also allows for a larger cafe space.
- 3 New moveable furniture to George Farha cafe to allow for flexibility.
- 4 Reconfiguration of entry lobby to comply with Part M of the Building Regulations and BS 8300.
- 5 Refurbishment of WC facilities.



First Floor Plan

- 1 Huntley's Pub rooms and WCs refurbished
- 2 New study space provided for students with moveable partitions to allow for flexibility.
- 3 Computer cluster provided for students.
- 4 WCs reconfigured for efficiency and to provide more study space.
- 5 Kitchenette and store provided in the case of events being held.



Second Floor Plan

- 1 Huntley's Pub rooms and WCs refurbished
- 2 New study space provided for students with moveable partitions to allow for flexibility.
- 3 Computer cluster provided for students.
- 4 WCs reconfigured for efficiency and to provide more study space.
- 5 Kitchenette and store provided in the case of events being held.

### KEY

- |                                                                     |                                                                     |                                                                         |                                                                 |
|---------------------------------------------------------------------|---------------------------------------------------------------------|-------------------------------------------------------------------------|-----------------------------------------------------------------|
| <span style="color: orange;">■</span> - Clubs & Societies           | <span style="color: lightgreen;">■</span> - Sabbatical Officers     | <span style="color: cyan;">■</span> - Front of House                    | <span style="color: lightblue;">■</span> - Shared Resources     |
| <span style="color: brown;">■</span> - Commercial Services          | <span style="color: pink;">■</span> - Central Services              | <span style="color: green;">■</span> - UCLU Welcome Area                | <span style="color: grey;">■</span> - Circulation/Back of House |
| <span style="color: lightorange;">■</span> - Cafe/Bar Seating Area  | <span style="color: magenta;">■</span> - Marketing & Communications | <span style="color: lightgrey;">■</span> - Hot Desks                    | <span style="color: tan;">■</span> - WCs/Showers                |
| <span style="color: darkorange;">■</span> - Bar                     | <span style="color: red;">■</span> - Representations & Campaigns    | <span style="color: olive;">■</span> - Shared Meeting Rooms             | <span style="color: darkorange;">■</span> - Study Zone          |
| <span style="color: darkred;">■</span> - Volunteering Services Unit | <span style="color: purple;">■</span> - Advice Service              | <span style="color: lightgreen;">■</span> - Shared Breakout/Common Room |                                                                 |